



1 Golwg y Garreg, Betws Road, Ammanford, SA18 2HE

£375,000

- NEW BUILD
- CHOICE OF PLOTS
- FISRT PHASE RELEASED
- SOLAR PANELS
- AIR SOURCE HEAT PUMP
- 3 BEDROOMS



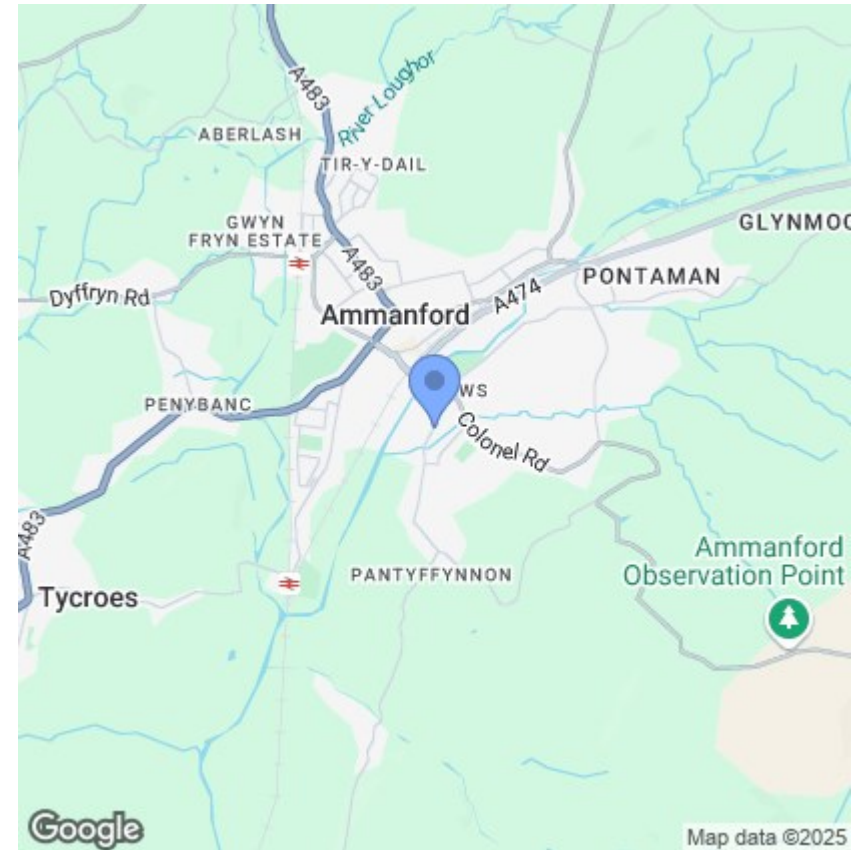
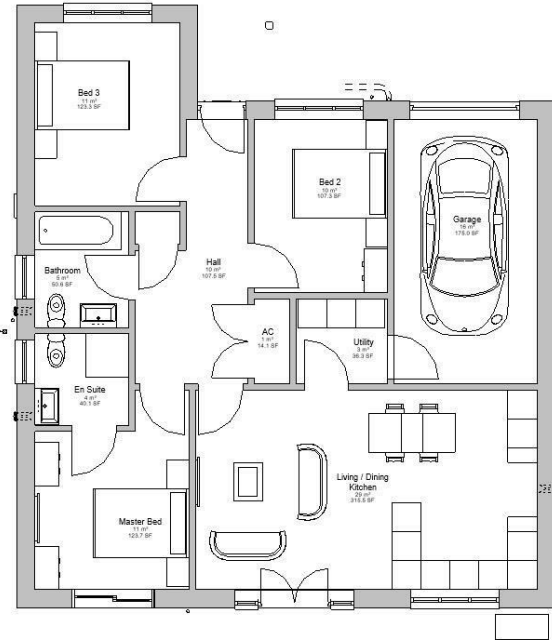
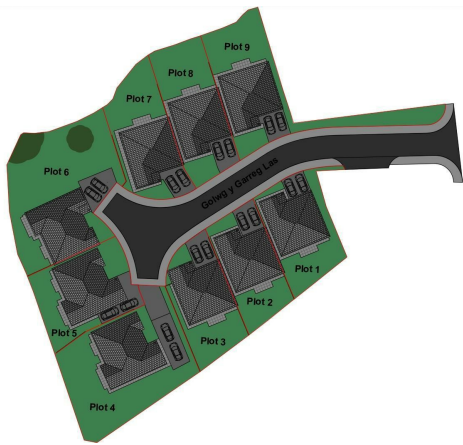

Description

Currently under construction with Plot 2 SOLD, and now available for reservation is a brand-new, detached bungalow in this exciting development by Gwyr Homes. Features such as Solar Panels and Air Source Heat Pump providing underfloor heating.

'Plot 1' is a spacious bungalow comprising three bedrooms, one with ensuite separate family bathroom, airing cupboard, separate utility room and contemporary open-plan living area.

All the amenities on offer at Ammanford Town Centre are easily accessible as is the M4 making it easy to access major roads, whichever direction you travel.

Directions

POSTCODE FOR SATNAV: SA18 2HE

Viewings

Viewings by arrangement only.

Call 01792 653100 to make an appointment.